

PARTS LIST							LENGTH	UNIT WT.	NET WT.
ITEM	QTY	PART NO.	BOX NO.	PART DESCRIPTION					
1	16	X-251012		BALLAST TRAY WELDMENT - SITE PRO 1			36.58	585.29	
2	64	CSRT-PCB	P-CSRT-PCB	CSRT PIPE CLAMP BRACKET KIT			4.25	271.71	
3	18	CSRT-GP30	P-CSRT-GP30	CSRT GUSSET PLATE KIT			10.49	188.73	
4	3	CSRT-GP30D	P-CSRT-GP30D	CSRT DUAL GUSSET PLATE KIT			12.64	37.92	
5	13	X-CSRT-3096FW		CSRT FLANGE PIPE WELDMENT 2-7/8" X 96"			51.47	669.05	
6	11	X-CSRT-3072FW		CSRT FLANGE PIPE WELDMENT 2-7/8" X 72"			39.16	430.71	
7	5	X-CSRT-3048FW		CSRT FLANGE PIPE WELDMENT 2-7/8" X 48"			26.85	134.23	
8	4	X-CSRT-P3096		2-7/8" DIA. PIPE X 96" LONG	96 in		48.99	195.98	
9	1	CSRT-TW1	P-CSRT-TW1	CSRT SINGLE T-WELDMENT KIT			7.84	7.84	
10	48	G12045		1/2" x 4.5" HDG HEX BOLT GR5 FULL THREAD	4 1/2 in		0.30	14.30	
11	60	G1202		1/2" x 2" HDG HEX BOLT GR5	2 in		0.18	10.54	
12	56	G12LW		1/2" HDG LOCKWASHER	1/8 in		0.01	0.78	
13	56	G12NUT		1/2" HDG HEAVY 2H HEX NUT	7/8 in		0.07	4.01	
								TOTAL WT. #	2551.10

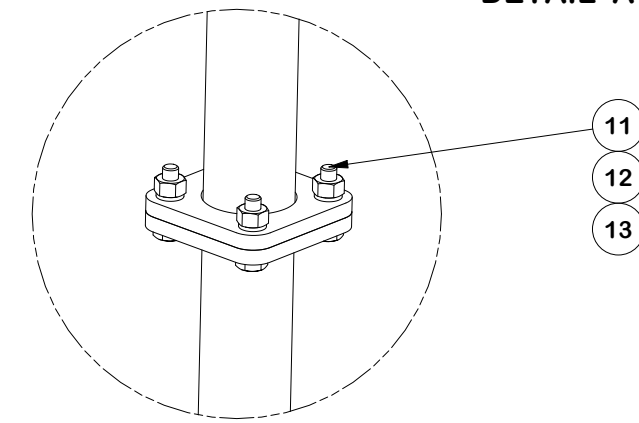
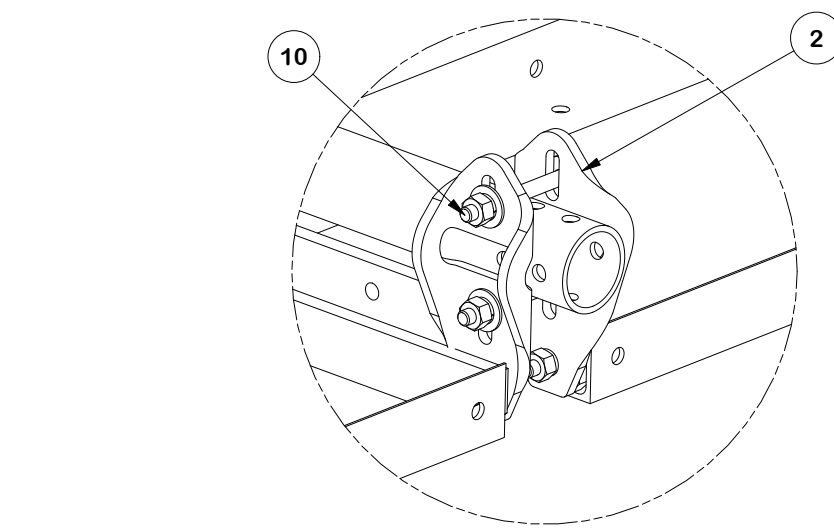
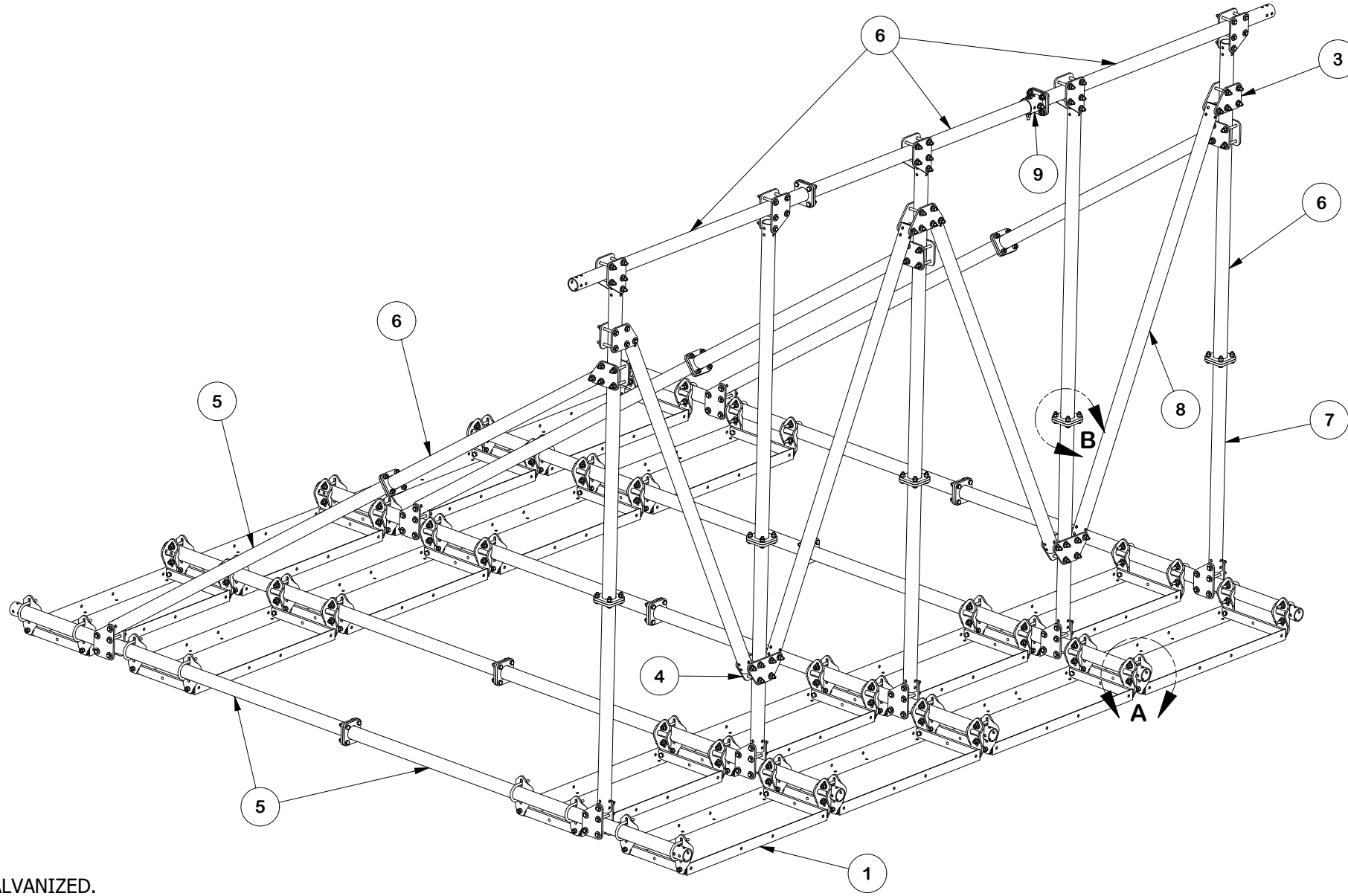

FINISH:
HOT DIP GALVANIZED.

TOLERANCE NOTES
 TOLERANCES ON DIMENSIONS, UNLESS OTHERWISE NOTED ARE:
 SAWED, SHEARED AND GAS CUT EDGES ($\pm 0.030"$)
 DRILLED AND GAS CUT HOLES ($\pm 0.030"$) - NO CONING OF HOLES
 LASER CUT EDGES AND HOLES ($\pm 0.010"$) - NO CONING OF HOLES
 BENDS AND ANGLES ARE $\pm 1/2$ DEGREE
 ALL OTHER MACHINING ($\pm 0.030"$)
 ALL OTHER ASSEMBLY ($\pm 0.060"$)

PATENT INFORMATION: WWW.SITEPRO1.COM/PATENTS

PROPRIETARY NOTE:
 THE DATA AND TECHNIQUES CONTAINED IN THIS DRAWING ARE PROPRIETARY INFORMATION OF VALMONT INDUSTRIES AND CONSIDERED A TRADE SECRET. ANY USE OR DISCLOSURE WITHOUT THE CONSENT OF VALMONT INDUSTRIES IS STRICTLY PROHIBITED.

DESCRIPTION
CSRT SERIES™ 3 PIPE SLOPE MOUNT
16' FACE X 10' MAST X 16' DEPTH

CPD NO. **NCS**
 DRAWN BY **SDR 10/6/2025**
 ENG. APPROVAL **11/11/2025**

CLASS **87** SUB **02**
 DRAWING USAGE **CUSTOMER**
 CHECKED BY **ADB 11/11/2025**

SITE PRO 1
 A valmont COMPANY

Engineering Support Team:
 sp1engineering@valmont.com

PART NO. **CSRT5-161016**
 DWG. NO. **CSRT5-161016**

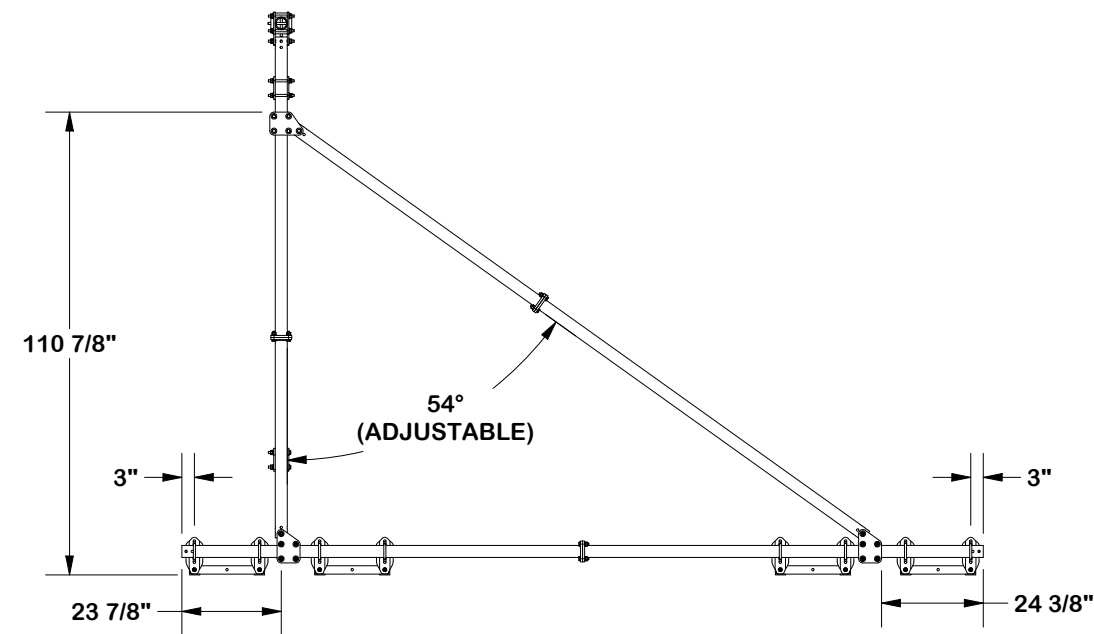
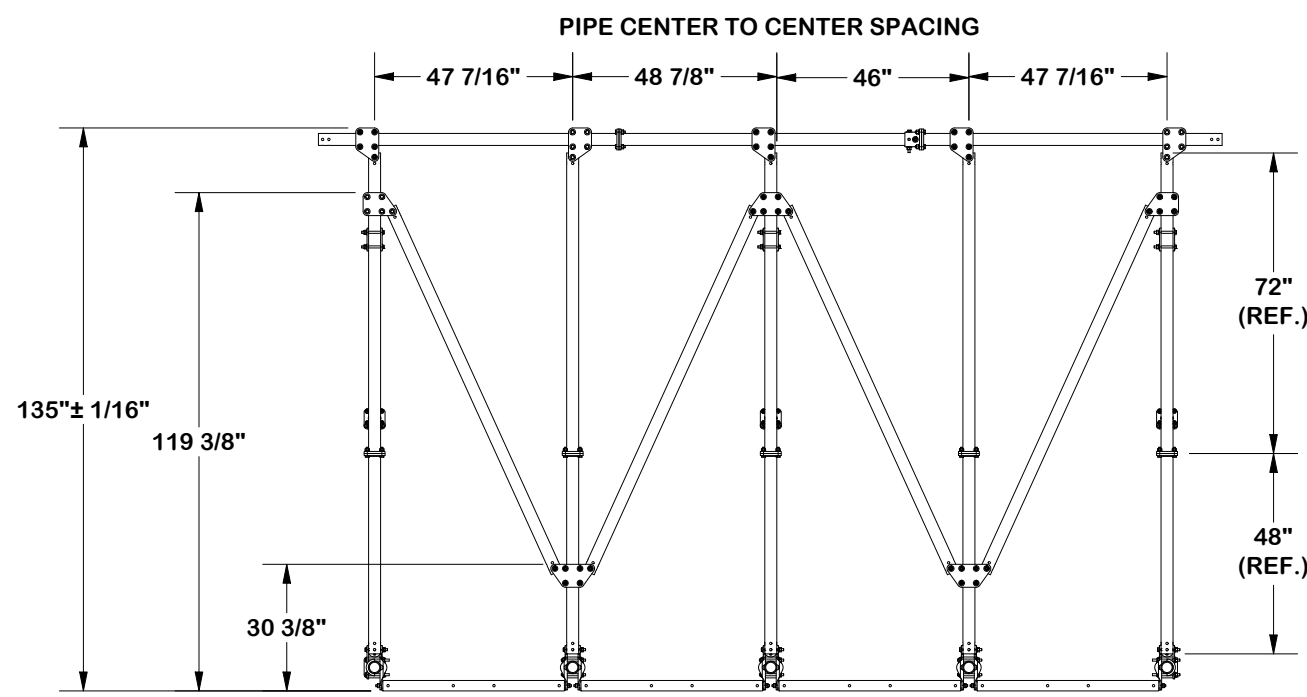
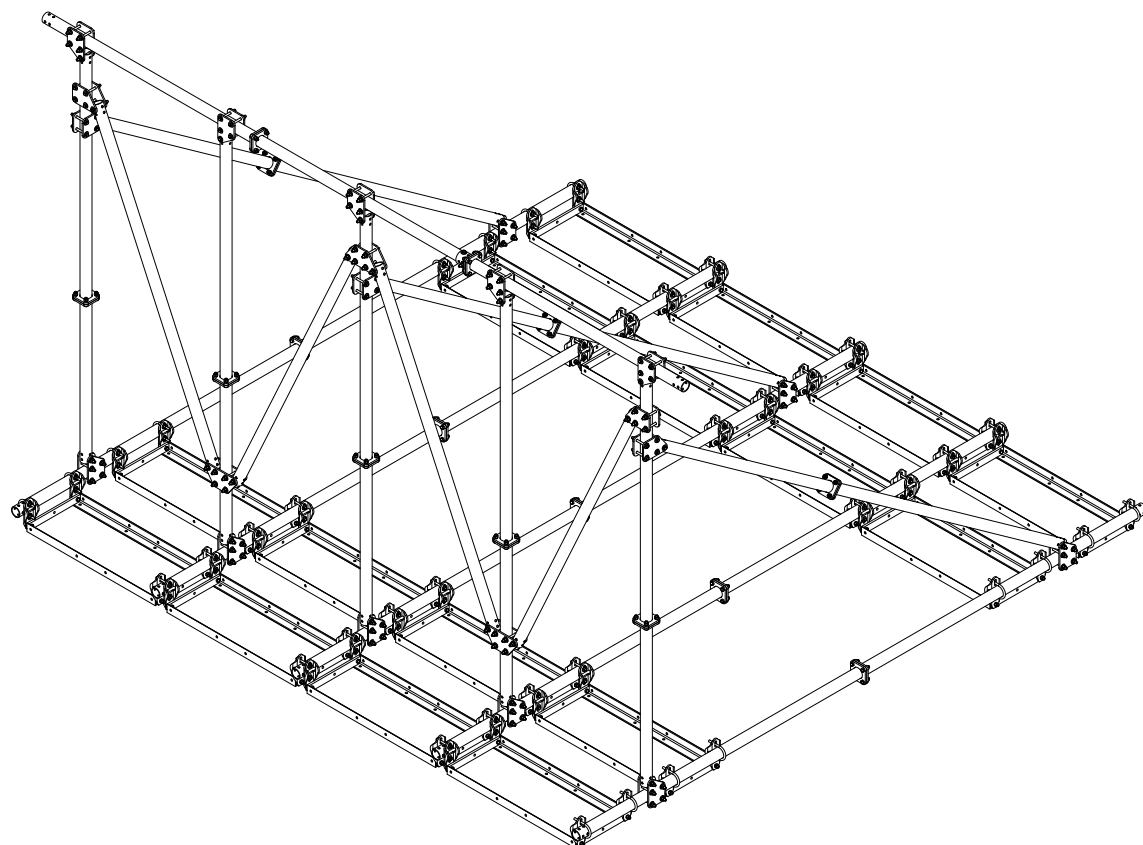
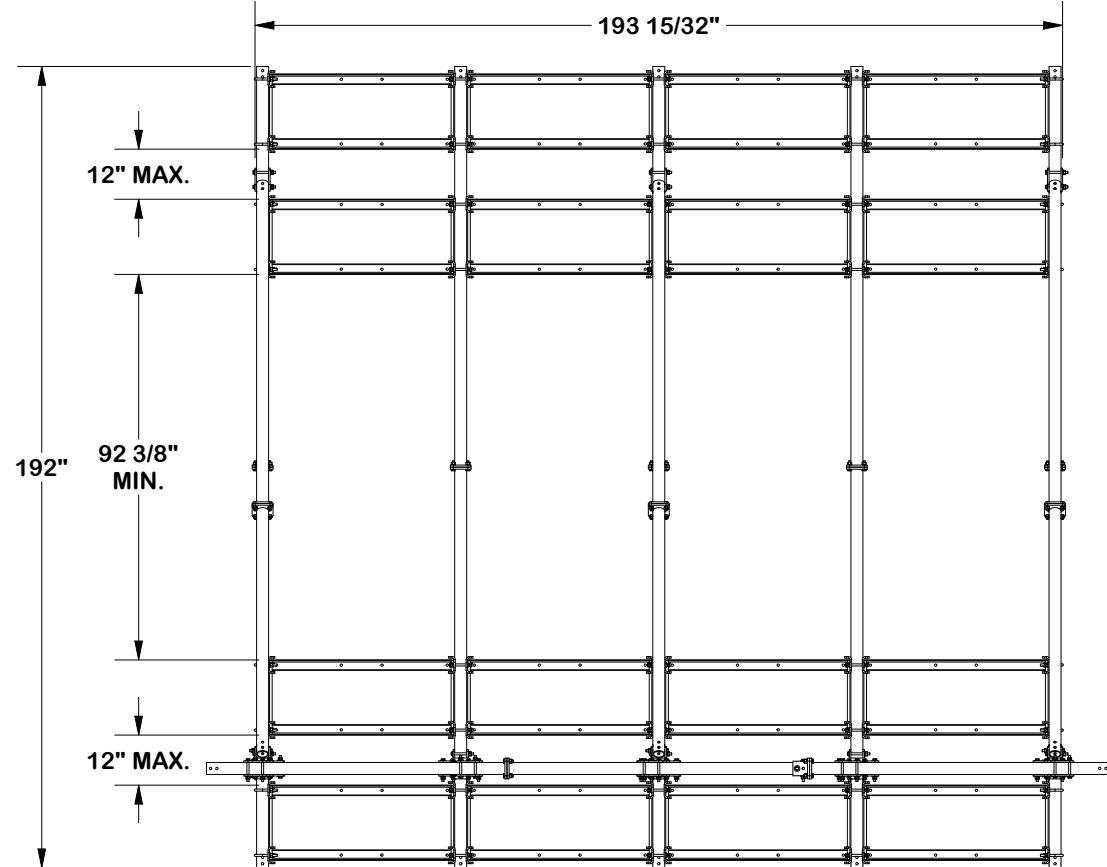

TOLERANCE NOTES

TOLERANCES ON DIMENSIONS, UNLESS OTHERWISE NOTED ARE:
 SAWED, SHEARED AND GAS CUT EDGES ($\pm 0.030"$)
 DRILLED AND GAS CUT HOLES ($\pm 0.030"$) - NO CONING OF HOLES
 LASER CUT EDGES AND HOLES ($\pm 0.010"$) - NO CONING OF HOLES
 BENDS AND ANGLES ARE $\pm 1/2$ DEGREE
 ALL OTHER MACHINING ($\pm 0.030"$)
 ALL OTHER ASSEMBLY ($\pm 0.060"$)

PATENT INFORMATION: WWW.SITEPRO1.COM/PATENTS

PROPRIETARY NOTE:
 THE DATA AND TECHNIQUES CONTAINED IN THIS DRAWING ARE PROPRIETARY INFORMATION OF VALMONT INDUSTRIES AND CONSIDERED A TRADE SECRET. ANY USE OR DISCLOSURE WITHOUT THE CONSENT OF VALMONT INDUSTRIES IS STRICTLY PROHIBITED.

DESCRIPTION
CSRT SERIES™ 3 PIPE SLOPE MOUNT
16' FACE X 10' MAST X 16' DEPTH



Engineering Support Team:
 sp1engineering@valmont.com

CPD NO. NCS	DRAWN BY SDR 10/6/2025	ENG. APPROVAL 11/11/2025
CLASS 87	SUB 02	DRAWING USAGE CUSTOMER
CHECKED BY ADB 11/11/2025		

PART NO. CSRT5-161016
DWG. NO. CSRT5-161016

CSRT™ SLOPE REFERENCE

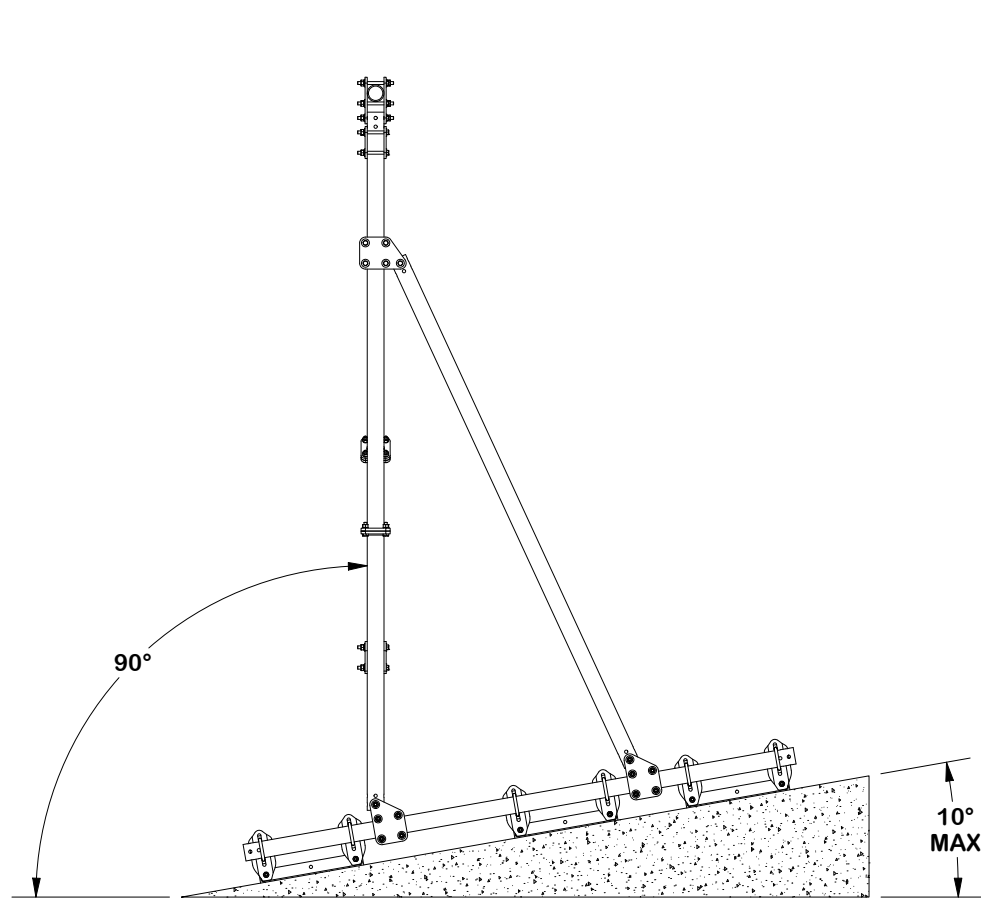

**RIGHT SIDE VIEW
FRONT SLOPE**

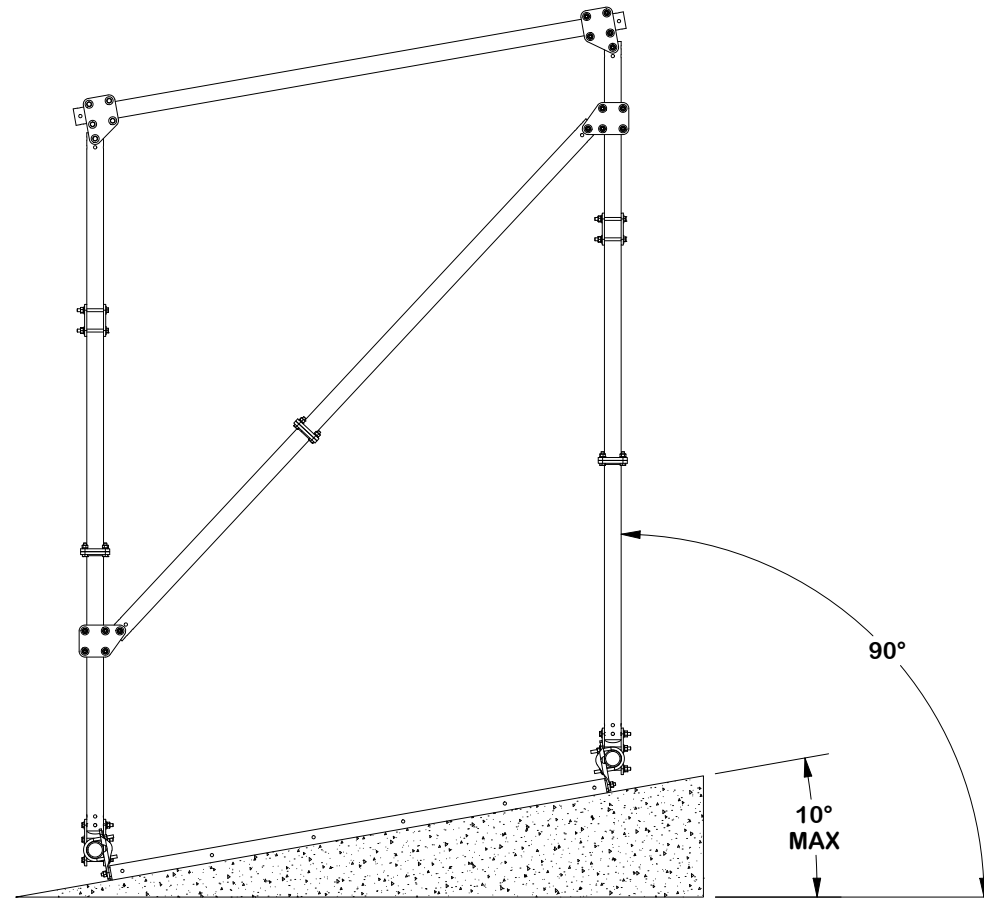

**FRONT VIEW
SIDE SLOPE**

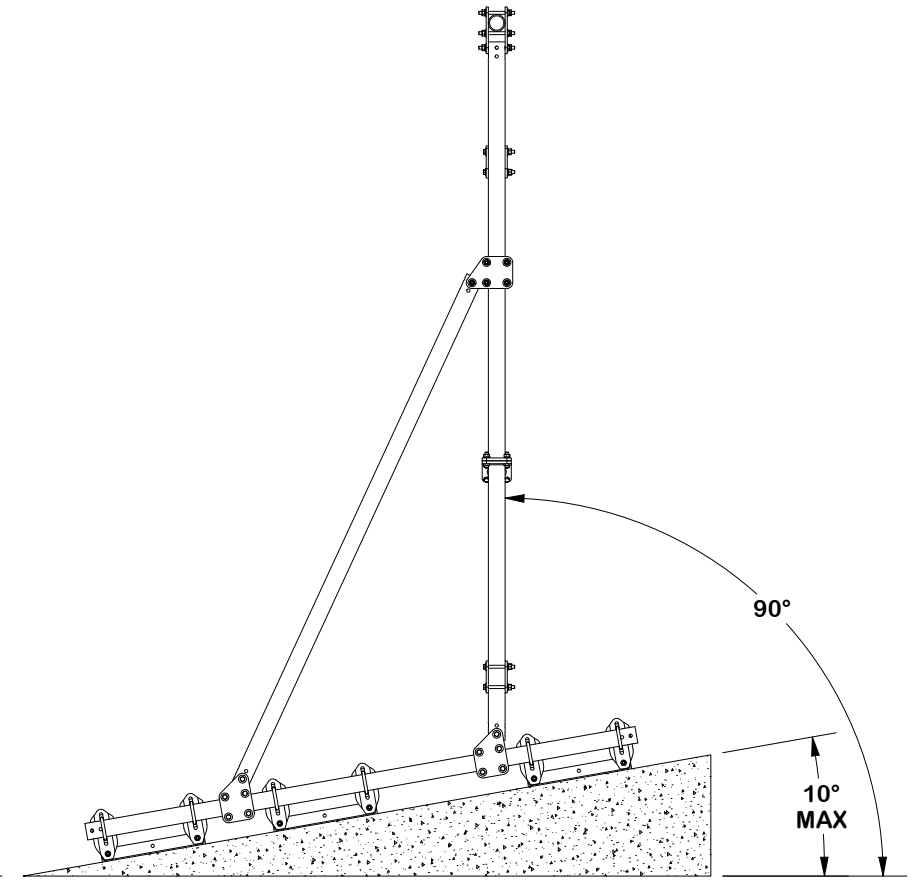

**LEFT SIDE VIEW
BACK SLOPE**

TOLERANCE NOTES

TOLERANCES ON DIMENSIONS, UNLESS OTHERWISE NOTED ARE:
 SAWED, SHEARED AND GAS CUT EDGES ($\pm 0.030"$)
 DRILLED AND GAS CUT HOLES ($\pm 0.030"$) - NO CONING OF HOLES
 LASER CUT EDGES AND HOLES ($\pm 0.010"$) - NO CONING OF HOLES
 BENDS AND ANGLES ARE $\pm 1/2$ DEGREE
 ALL OTHER MACHINING ($\pm 0.030"$)
 ALL OTHER ASSEMBLY ($\pm 0.060"$)

PATENT INFORMATION: WWW.SITEPRO1.COM/PATENTS

PROPRIETARY NOTE:
 THE DATA AND TECHNIQUES CONTAINED IN THIS DRAWING ARE PROPRIETARY INFORMATION OF VALMONT INDUSTRIES AND CONSIDERED A TRADE SECRET. ANY USE OR DISCLOSURE WITHOUT THE CONSENT OF VALMONT INDUSTRIES IS STRICTLY PROHIBITED.

DESCRIPTION
**CSRT SERIES™ 3 PIPE SLOPE MOUNT
 16' FACE X 10' MAST X 16' DEPTH**

CPD NO. NCS	DRAWN BY SDR 10/6/2025	ENG. APPROVAL 11/11/2025
CLASS 87	SUB 02	DRAWING USAGE CUSTOMER
		CHECKED BY ADB 11/11/2025



A **valmont** COMPANY

Engineering
Support Team:
sp1engineering@valmont.com

PART NO. CSRT™ SLOPE REF
DWG. NO. CSRT5-161016

PARTS LIST						
ITEM	QTY	PART NO.	PART DESCRIPTION	LENGTH	UNIT WT.	NET WT.
1	1	X-CSRT-PCB	PIPE CONNECTION BRACKET	12 in	3.01	3.01
2	1	X-UB1300	1/2" X 3" X 5" X 2" GALV U-BOLT		0.74	0.74
3	1	G1202	1/2" x 2" HDG HEX BOLT GR5	2 in	0.18	0.18
4	2	G12FW	1/2" HDG USS FLATWASHER	3/32 in	0.03	0.07
5	3	G12LW	1/2" HDG LOCKWASHER	1/8 in	0.01	0.04
6	3	G12NUT	1/2" HDG HEAVY 2H HEX NUT	7/8 in	0.07	0.21
					TOTAL WT. #	4.25

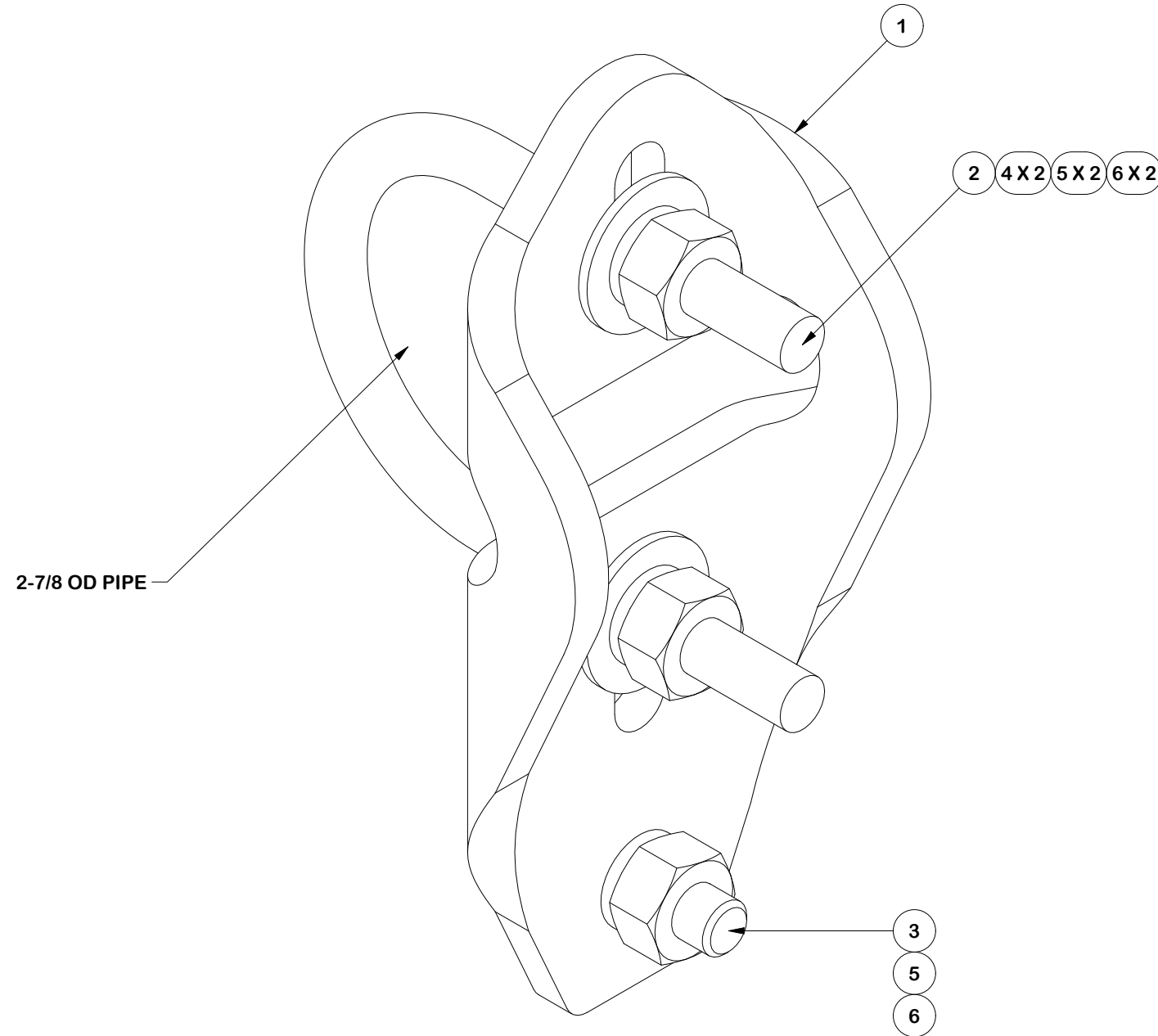

FINISH:
HOT DIP GALVANIZED.

TOLERANCE NOTES

TOLERANCES ON DIMENSIONS, UNLESS OTHERWISE NOTED ARE:
 SAWED, SHEARED AND GAS CUT EDGES ($\pm 0.030"$)
 DRILLED AND GAS CUT HOLES ($\pm 0.030"$) - NO CONING OF HOLES
 LASER CUT EDGES AND HOLES ($\pm 0.010"$) - NO CONING OF HOLES
 BENDS AND ANGLES ARE $\pm 1/2$ DEGREE
 ALL OTHER MACHINING ($\pm 0.030"$)
 ALL OTHER ASSEMBLY ($\pm 0.060"$)

PATENT INFORMATION: WWW.SITEPRO1.COM/PATENTS

PROPRIETARY NOTE:
 THE DATA AND TECHNIQUES CONTAINED IN THIS DRAWING ARE PROPRIETARY INFORMATION OF VALMONT INDUSTRIES AND CONSIDERED A TRADE SECRET. ANY USE OR DISCLOSURE WITHOUT THE CONSENT OF VALMONT INDUSTRIES IS STRICTLY PROHIBITED.

DESCRIPTION
**CSRT SERIES™ 3 PIPE SLOPE MOUNT
 16' FACE X 10' MAST X 16' DEPTH**



Engineering
 Support Team:
 sp1engineering@valmont.com

CPD NO. NCS	DRAWN BY SDR 10/6/2025	ENG. APPROVAL 11/11/2025
CLASS 87	SUB 02	DRAWING USAGE CUSTOMER
CHECKED BY ADB 11/11/2025		

PART NO. CSRT-PCB
DWG. NO. CSRT5-161016

PARTS LIST						
ITEM	QTY	PART NO.	PART DESCRIPTION	LENGTH	UNIT WT.	NET WT.
1	2	X-CSRT-GP30	3" GUSSET PLATE	12 in	4.04	8.09
2	5	G1205	1/2" x 5" HDG HEX BOLT GR5 FULL THREAD	5 in	0.33	1.63
3	10	G12FW	1/2" HDG USS FLATWASHER	3/32 in	0.03	0.34
4	5	G12LW	1/2" HDG LOCKWASHER	1/8 in	0.01	0.07
5	5	G12NUT	1/2" HDG HEAVY 2H HEX NUT	7/8 in	0.07	0.36
					TOTAL WT. #	10.49

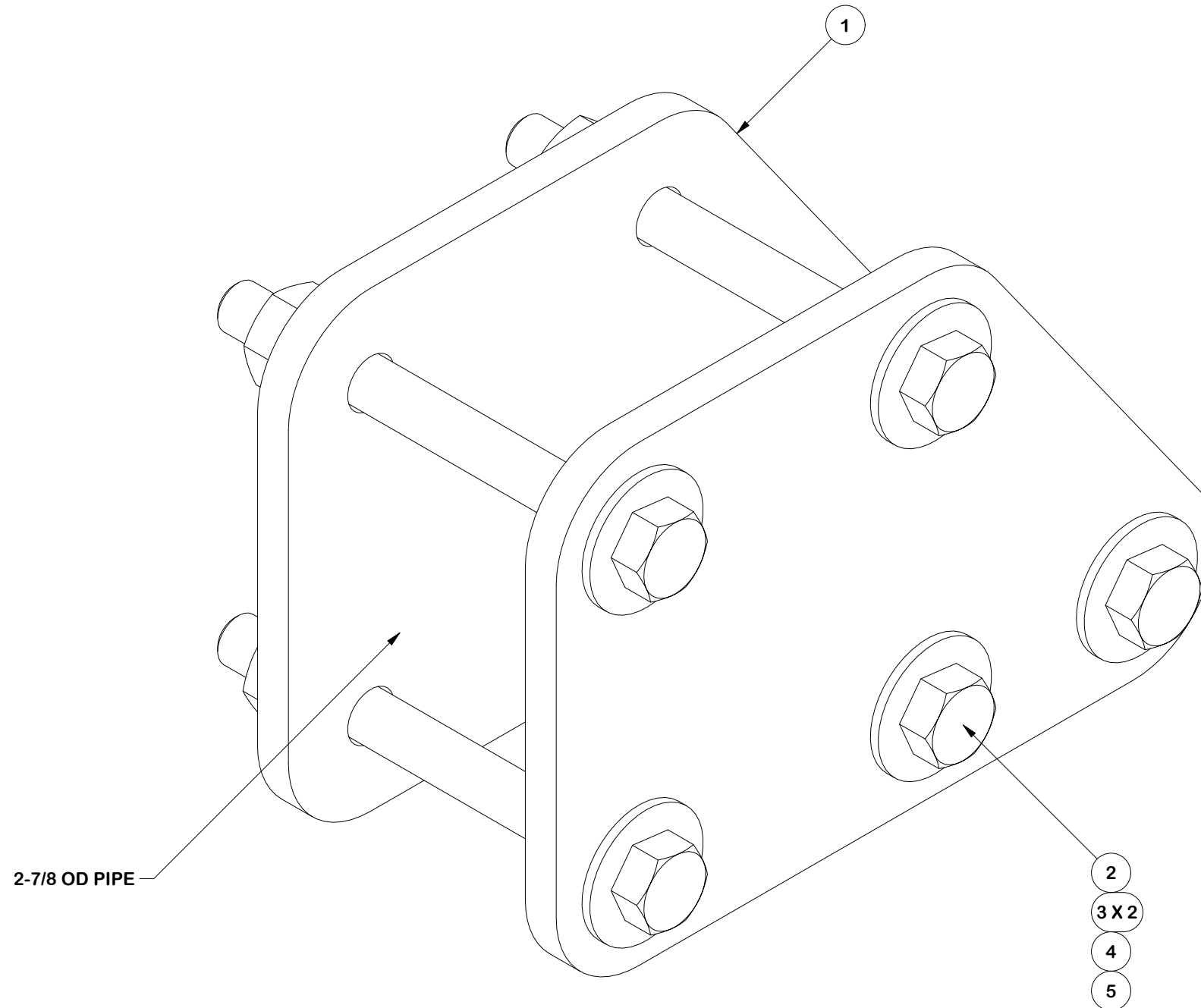

FINISH:
HOT DIP GALVANIZED.

TOLERANCE NOTES

TOLERANCES ON DIMENSIONS, UNLESS OTHERWISE NOTED ARE:
 SAWED, SHEARED AND GAS CUT EDGES ($\pm 0.030"$)
 DRILLED AND GAS CUT HOLES ($\pm 0.030"$) - NO CONING OF HOLES
 LASER CUT EDGES AND HOLES ($\pm 0.010"$) - NO CONING OF HOLES
 BENDS AND ANGLES ARE $\pm 1/2$ DEGREE
 ALL OTHER MACHINING ($\pm 0.030"$)
 ALL OTHER ASSEMBLY ($\pm 0.060"$)

PATENT INFORMATION: WWW.SITEPRO1.COM/PATENTS

PROPRIETARY NOTE:
 THE DATA AND TECHNIQUES CONTAINED IN THIS DRAWING ARE PROPRIETARY INFORMATION OF VALMONT INDUSTRIES AND CONSIDERED A TRADE SECRET. ANY USE OR DISCLOSURE WITHOUT THE CONSENT OF VALMONT INDUSTRIES IS STRICTLY PROHIBITED.

DESCRIPTION
**CSRT SERIES™ 3 PIPE SLOPE MOUNT
 16' FACE X 10' MAST X 16' DEPTH**

CPD NO. NCS	DRAWN BY SDR 10/6/2025	ENG. APPROVAL 11/11/2025
CLASS 87	SUB 02	DRAWING USAGE CUSTOMER
CHECKED BY ADB 11/11/2025		

SITE PRO 1
 A valmont COMPANY

Engineering Support Team:
 sp1engineering@valmont.com

PART NO. CSRT-GP30	PAGE 5 OF 7
DWG. NO. CSRT5-161016	

PARTS LIST						
ITEM	QTY	PART NO.	PART DESCRIPTION	LENGTH	UNIT WT.	NET WT.
1	2	X-CSRT-GP30D	3" DOUBLE GUSSET PLATE	24 in	4.88	9.76
2	6	G1205	1/2" x 5" HDG HEX BOLT GR5 FULL THREAD	5 in	0.33	1.96
3	12	G12FW	1/2" HDG USS FLATWASHER	3/32 in	0.03	0.41
4	6	G12LW	1/2" HDG LOCKWASHER	1/8 in	0.01	0.08
5	6	G12NUT	1/2" HDG HEAVY 2H HEX NUT	7/8 in	0.07	0.43
					TOTAL WT. #	12.64

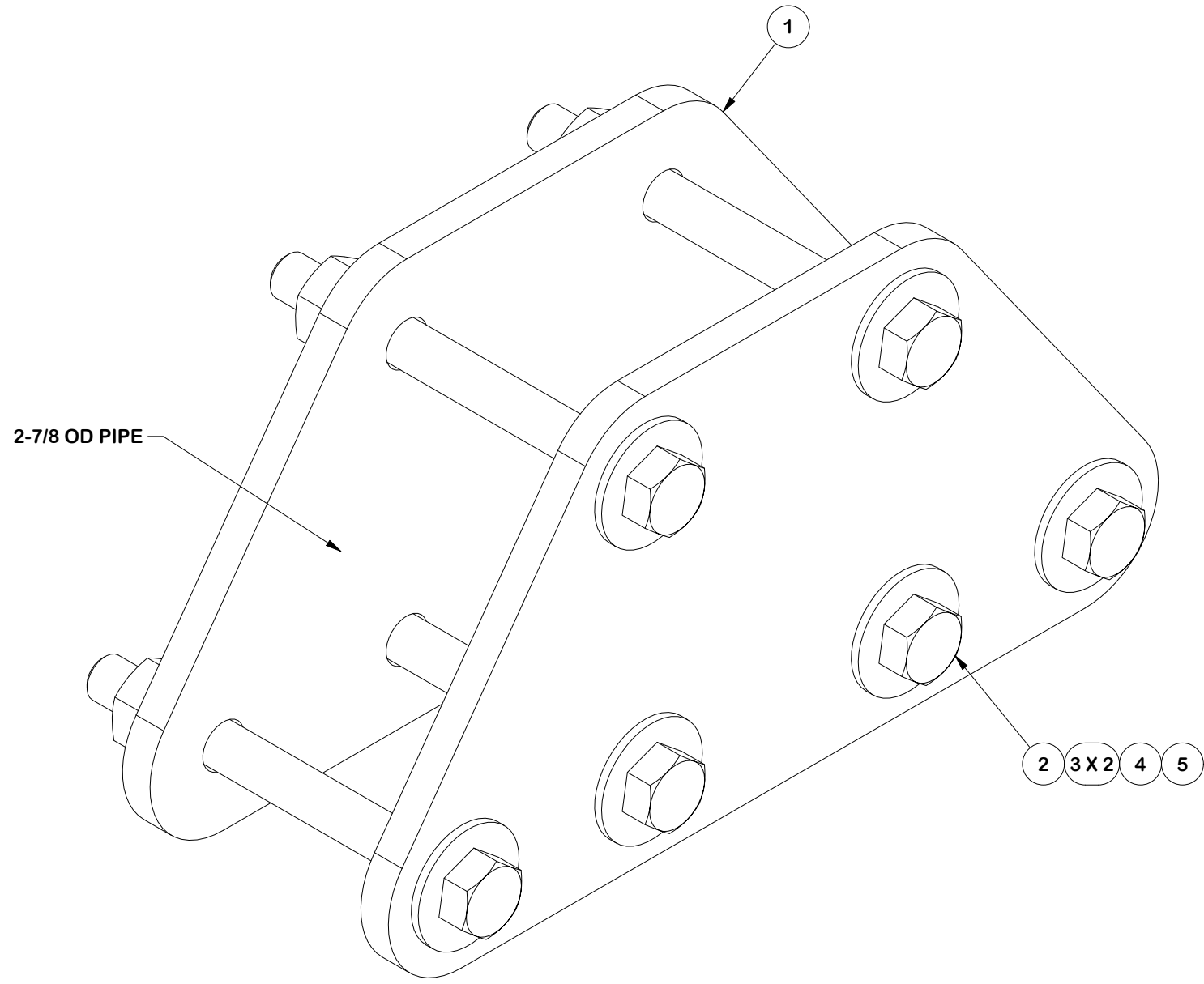

FINISH:
HOT DIP GALVANIZED.

TOLERANCE NOTES

TOLERANCES ON DIMENSIONS, UNLESS OTHERWISE NOTED ARE:
 SAWED, SHEARED AND GAS CUT EDGES ($\pm 0.030"$)
 DRILLED AND GAS CUT HOLES ($\pm 0.030"$) - NO CONING OF HOLES
 LASER CUT EDGES AND HOLES ($\pm 0.010"$) - NO CONING OF HOLES
 BENDS AND ANGLES ARE $\pm 1/2$ DEGREE
 ALL OTHER MACHINING ($\pm 0.030"$)
 ALL OTHER ASSEMBLY ($\pm 0.060"$)

PATENT INFORMATION: WWW.SITEPRO1.COM/PATENTS

PROPRIETARY NOTE:
 THE DATA AND TECHNIQUES CONTAINED IN THIS DRAWING ARE PROPRIETARY INFORMATION OF VALMONT INDUSTRIES AND CONSIDERED A TRADE SECRET. ANY USE OR DISCLOSURE WITHOUT THE CONSENT OF VALMONT INDUSTRIES IS STRICTLY PROHIBITED.

DESCRIPTION
**CSRT SERIES™ 3 PIPE SLOPE MOUNT
 16' FACE X 10' MAST X 16' DEPTH**

SITE PRO 1
 A valmont COMPANY
 Engineering Support Team:
 sp1engineering@valmont.com

CPD NO. NCS	DRAWN BY SDR 10/6/2025	ENG. APPROVAL 11/11/2025
CLASS 87	SUB 02	DRAWING USAGE CUSTOMER
CHECKED BY ADB 11/11/2025		

PART NO. CSRT-GP30D	PAGE 6 OF 7
DWG. NO. CSRT5-161016	

PARTS LIST						
ITEM	QTY	PART NO.	PART DESCRIPTION	LENGTH	UNIT WT.	NET WT.
1	1	X-CSRT-TW	3-1/2" T-WELDMENT		4.93	4.93
2	2	X-UB1300	1/2" X 3" X 5" X 2" GALV U-BOLT		0.74	1.48
3	2	G1205	1/2" x 5" HDG HEX BOLT GR5 FULL THREAD	5 in	0.33	0.65
4	8	G12FW	1/2" HDG USS FLATWASHER	3/32 in	0.03	0.27
5	6	G12LW	1/2" HDG LOCKWASHER	1/8 in	0.01	0.08
6	6	G12NUT	1/2" HDG HEAVY 2H HEX NUT	7/8 in	0.07	0.43
					TOTAL WT. #	7.84

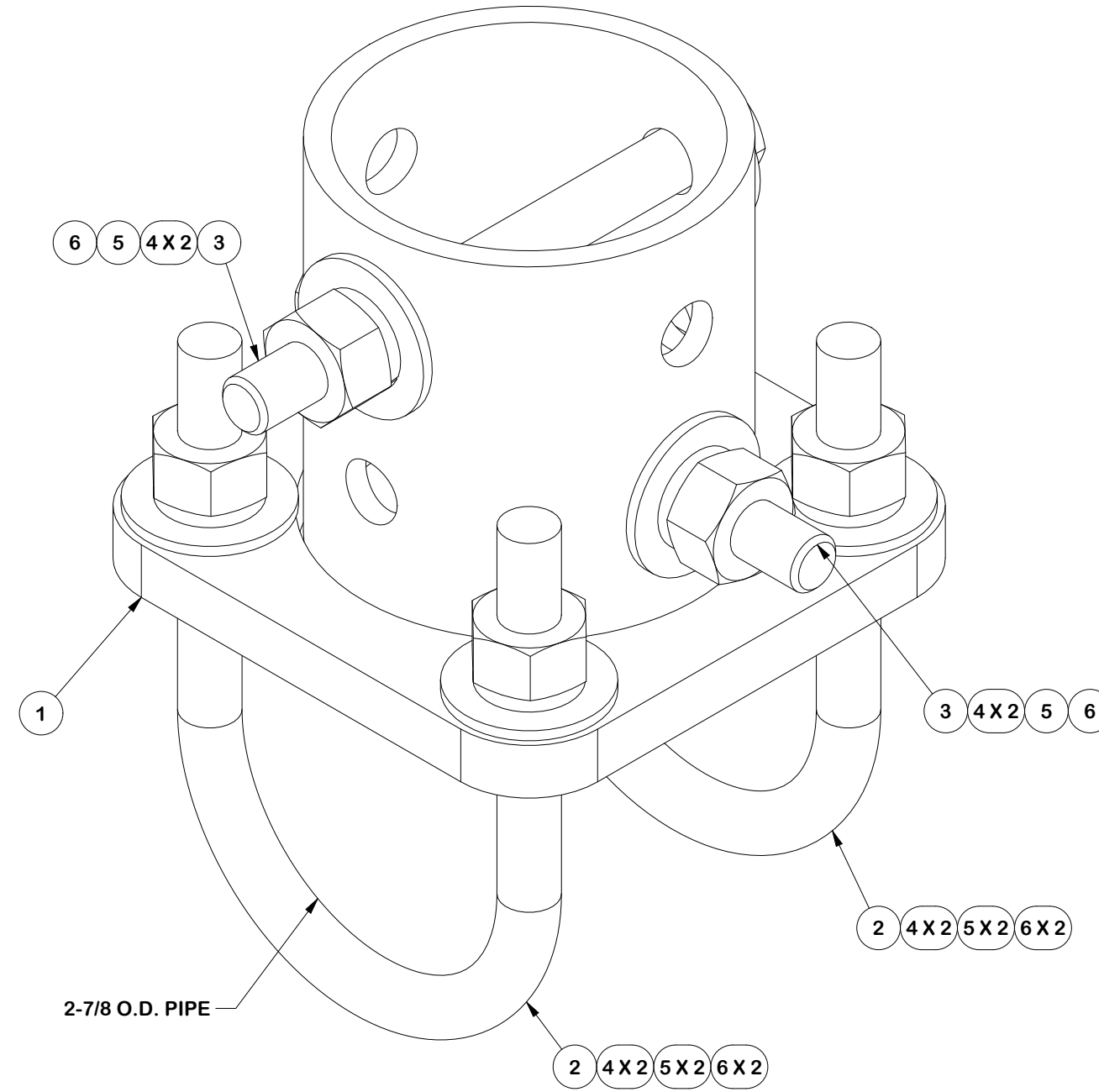

FINISH:
HOT DIP GALVANIZED.

TOLERANCE NOTES

TOLERANCES ON DIMENSIONS, UNLESS OTHERWISE NOTED ARE:
 SAWED, SHEARED AND GAS CUT EDGES ($\pm 0.030"$)
 DRILLED AND GAS CUT HOLES ($\pm 0.030"$) - NO CONING OF HOLES
 LASER CUT EDGES AND HOLES ($\pm 0.010"$) - NO CONING OF HOLES
 BENDS AND ANGLES ARE $\pm 1/2$ DEGREE
 ALL OTHER MACHINING ($\pm 0.030"$)
 ALL OTHER ASSEMBLY ($\pm 0.060"$)

PATENT INFORMATION: WWW.SITEPRO1.COM/PATENTS

PROPRIETARY NOTE:
 THE DATA AND TECHNIQUES CONTAINED IN THIS DRAWING ARE PROPRIETARY INFORMATION OF VALMONT INDUSTRIES AND CONSIDERED A TRADE SECRET. ANY USE OR DISCLOSURE WITHOUT THE CONSENT OF VALMONT INDUSTRIES IS STRICTLY PROHIBITED.

DESCRIPTION
**CSRT SERIES™ 3 PIPE SLOPE MOUNT
 16' FACE X 10' MAST X 16' DEPTH**



Engineering Support Team:
 sp1engineering@valmont.com

CPD NO. NCS	DRAWN BY SDR 10/6/2025	ENG. APPROVAL 11/11/2025
CLASS 87	SUB 02	DRAWING USAGE CUSTOMER
CHECKED BY ADB 11/11/2025		

PART NO. CSRT-TW1
DWG. NO. CSRT5-161016